

AiP10008

1/32 SCALE
FAB 1

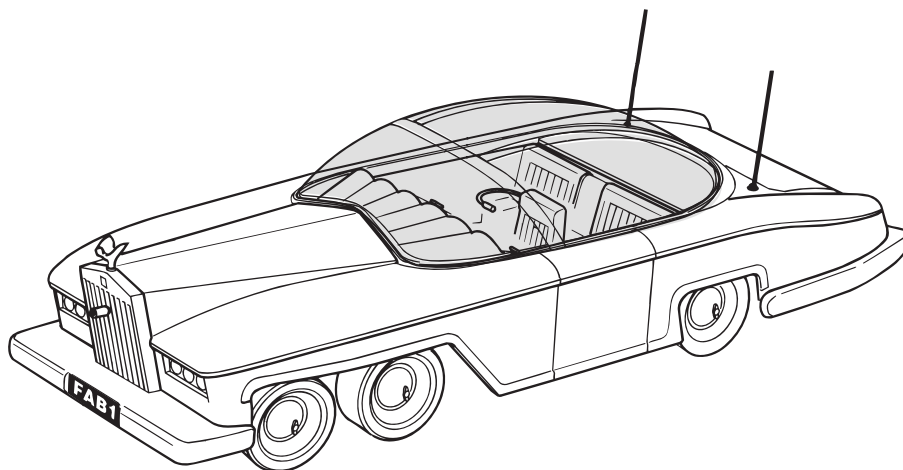

Paint colour references:

We recommend using the following Humbrol paint colours:
(Paints not included)

- 11** SILVER
- 21** GLOSS BLACK
- 22** GLOSS WHITE
- 53** GUNMETAL
- 60** MATT SCARLET
- 85** SATIN COAL BLACK
- 200** GLOSS PINK
- 1321** CLEAR RED (alternatively use Tamiya X-27 Clear Red)

The original Thunderbirds television series was produced in a time before CGI and computers. Skilled model makers and technicians created several models in varying scales depending on the shot required in the storyline. This coupled with camera lighting from different angles means the various craft do appear to be different colours in certain scenes. The paint codes provided are a basic guide and we would suggest watching the episodes and referring to the box photo for further detailed information.

How to apply decals:

Waterslide decals are supplied with this model kit.
Please follow these instructions when applying.

①

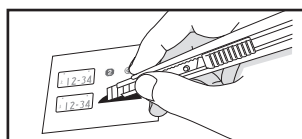

- Cut out the decal to the required shape using scissors or a craft blade.

②

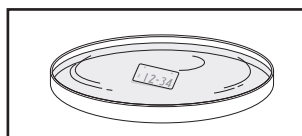

- Dip the decal in water for 10 to 20 seconds.

③

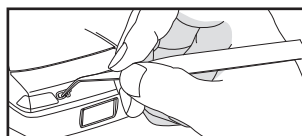

- Place decal in the desired position and slide it gently from the backing sheet using tweezers
- Adjust position if required and dry excess water with a soft cloth.

You will also need: (not included)



Plastic Cement



Super Glue



Sprue Nipper



Craft Knife



Tweezers

Symbol guide:

← Glue here

← - - - No glue required



ADVENTURES IN PLASTIC
A Bachmann Europe Production

13 Moat Way, Barwell, Leicestershire, LE9 8EY
01455 841756 • www.bachmann-europe.co.uk

Thunderbirds™ and © ITC Entertainment Group Limited 1964, 1999 and 2020. Licensed by ITV Ventures Limited. All rights reserved. © Bachmann Europe Plc 2019.



Carefully check the contents of the kit, including parts and decals, before assembly.

PARTS LIST

This kit does not include paints or glue. Please purchase them separately.

Body (I-03-99)

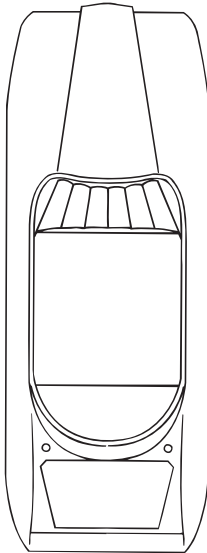

Chassis (I-03-101)

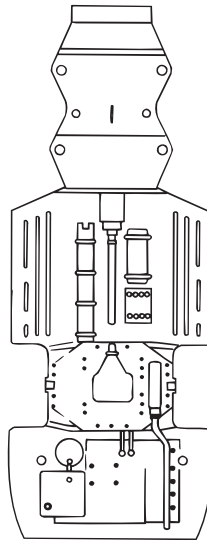

Chrome parts (I-03-101)

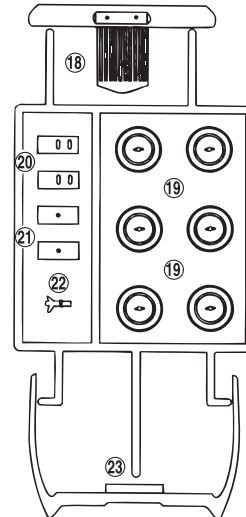

Interior (I-03-100)

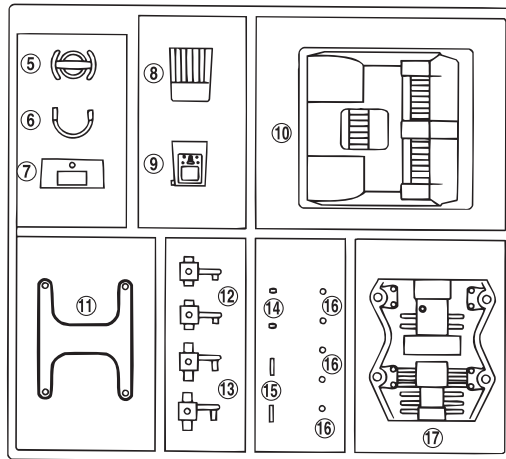

Clear parts (I-02-34)

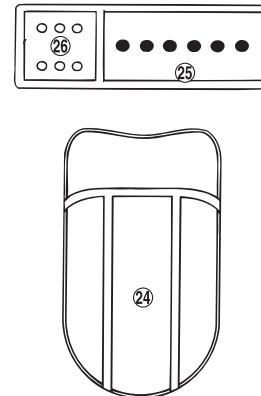

Bag A

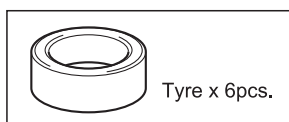

Bag B

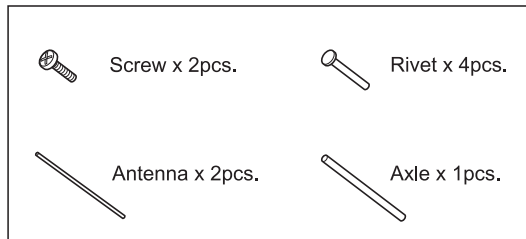

Decal

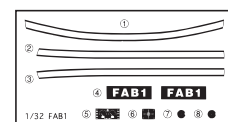

1 Rear wheel assembly

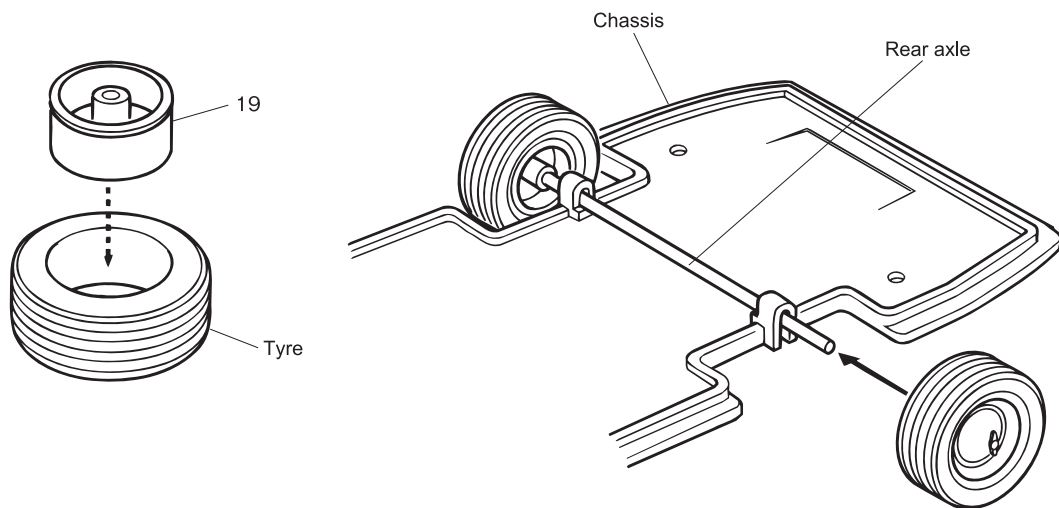

2 Front Wheels assembly

NOTE: Length of pins is different between 1st and 2nd row of wheels

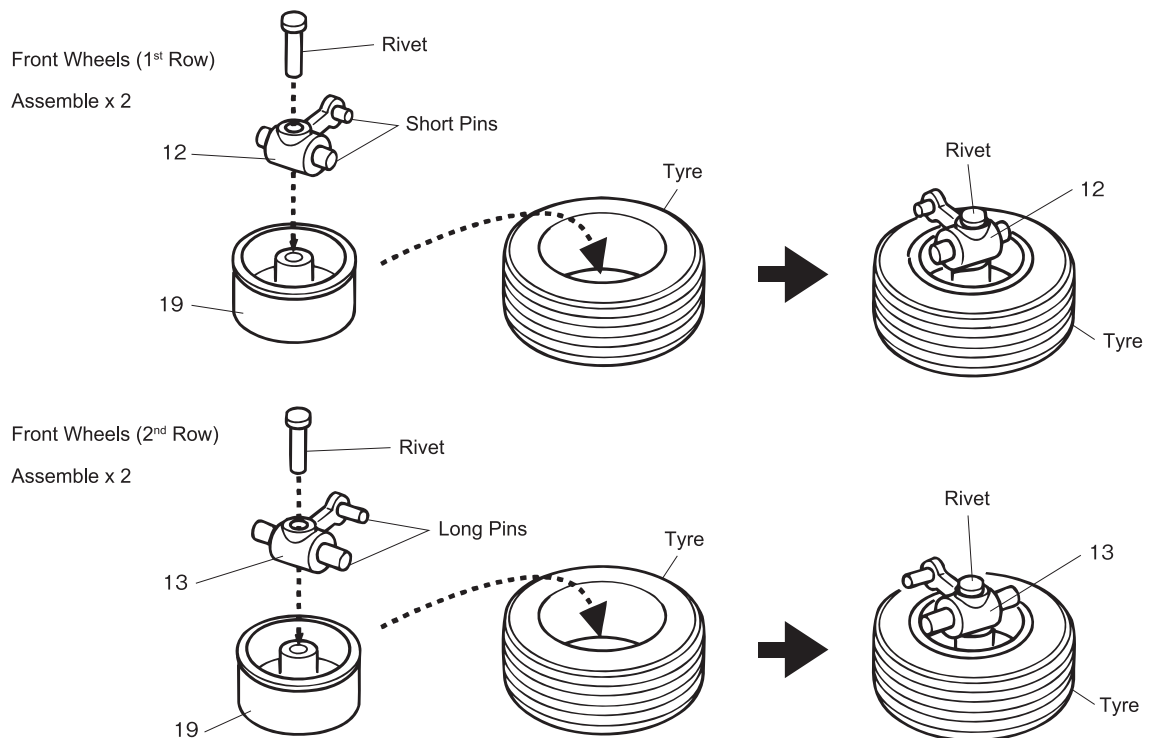

NOTE: Length of pins is different between 1st and 2nd row of wheels

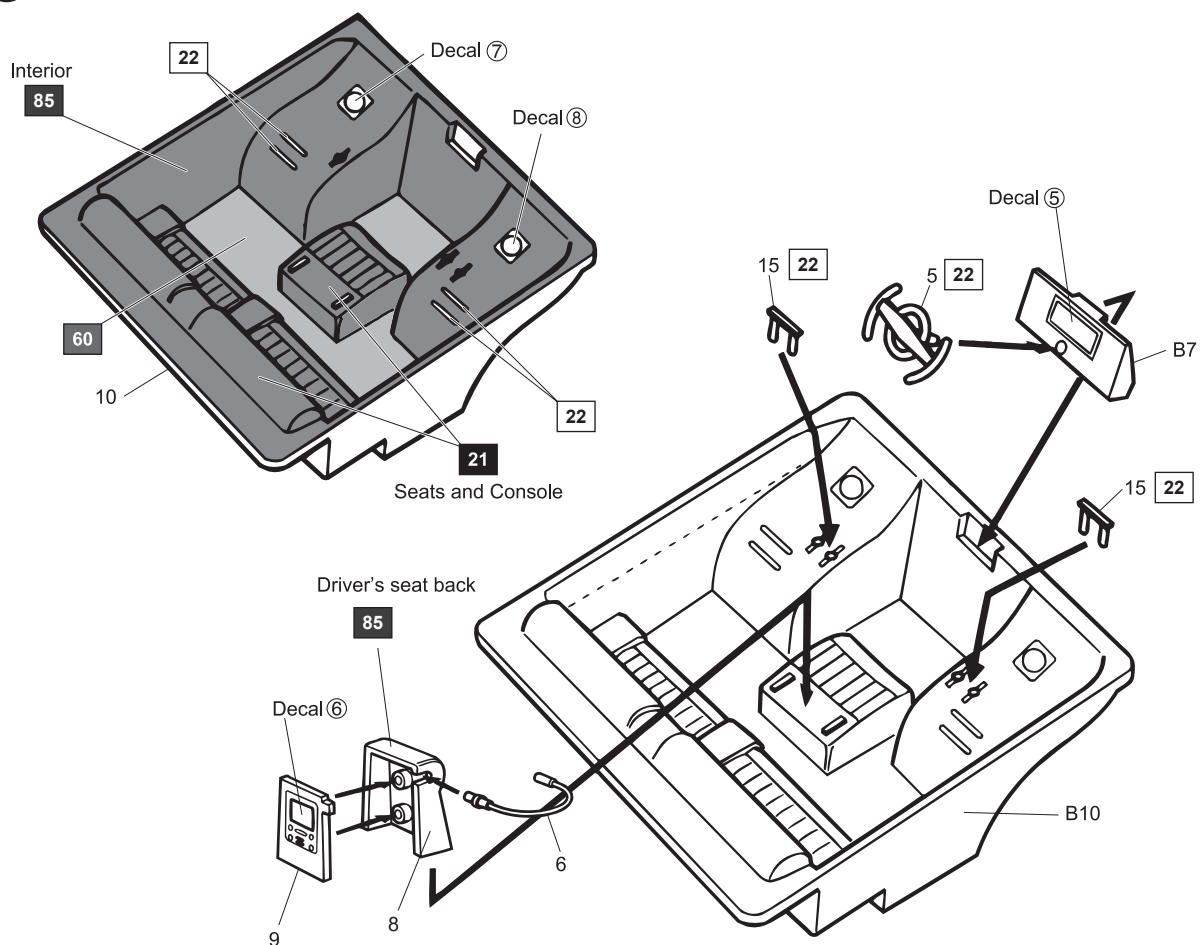

5 Headlight assembly

There are two headlight options:

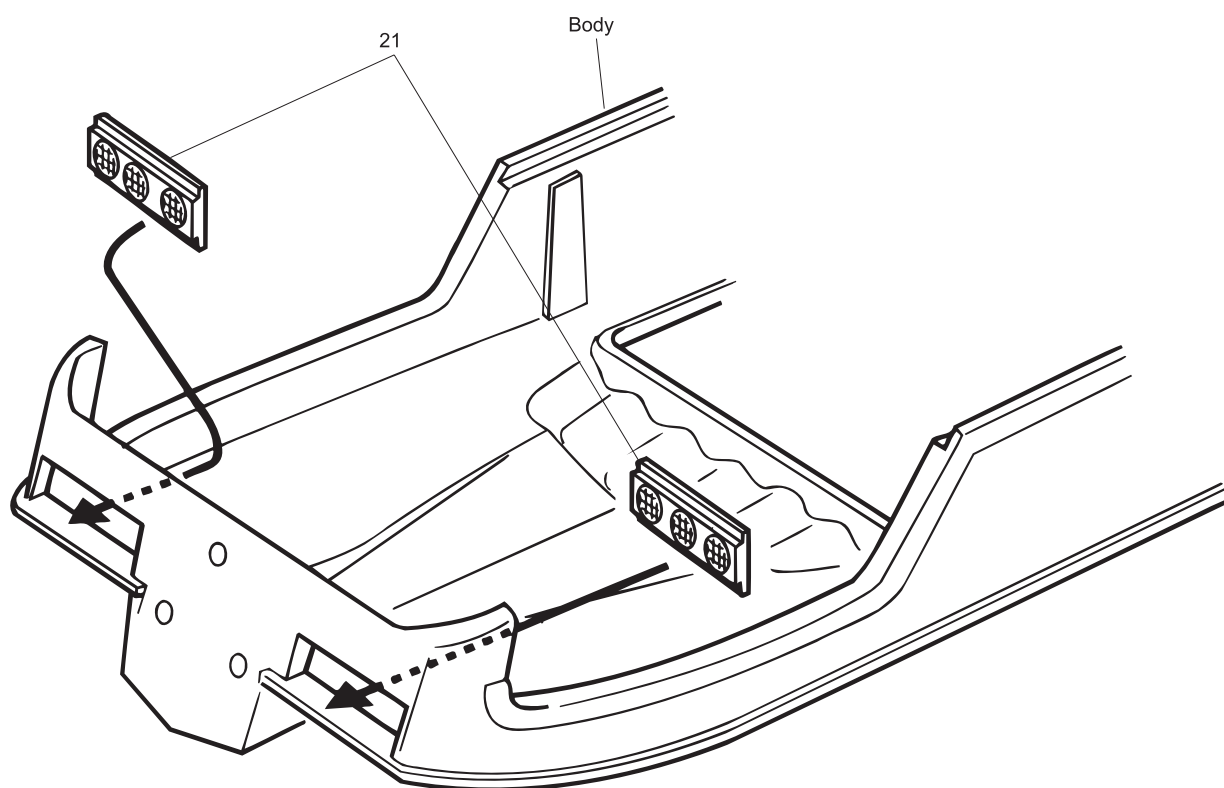
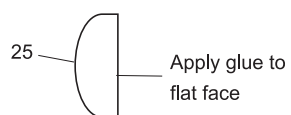
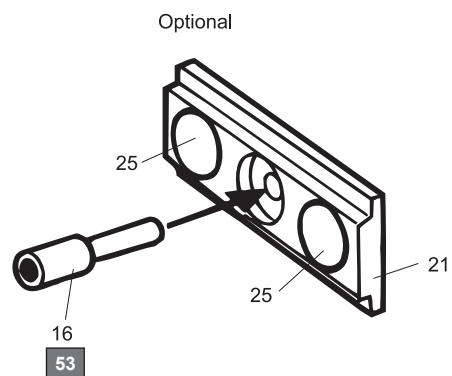
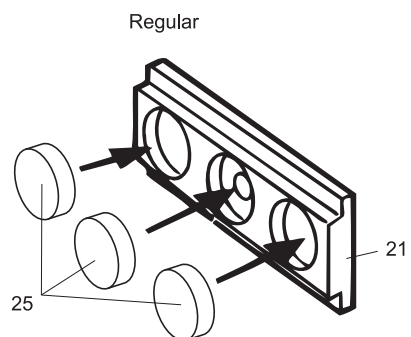

6 Tail light assembly

There are two tail light assembly options:

Regular

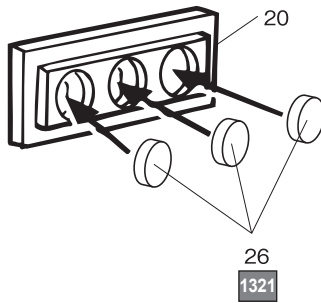

Optional (Left hand lights)

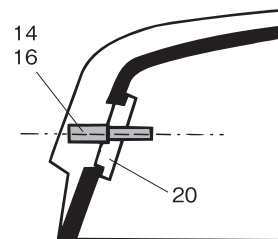
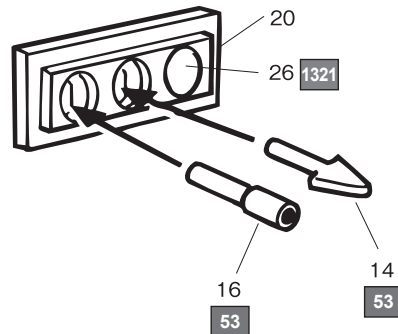

Fix the secret weapons 14 and 16 to the body ensuring they are horizontal

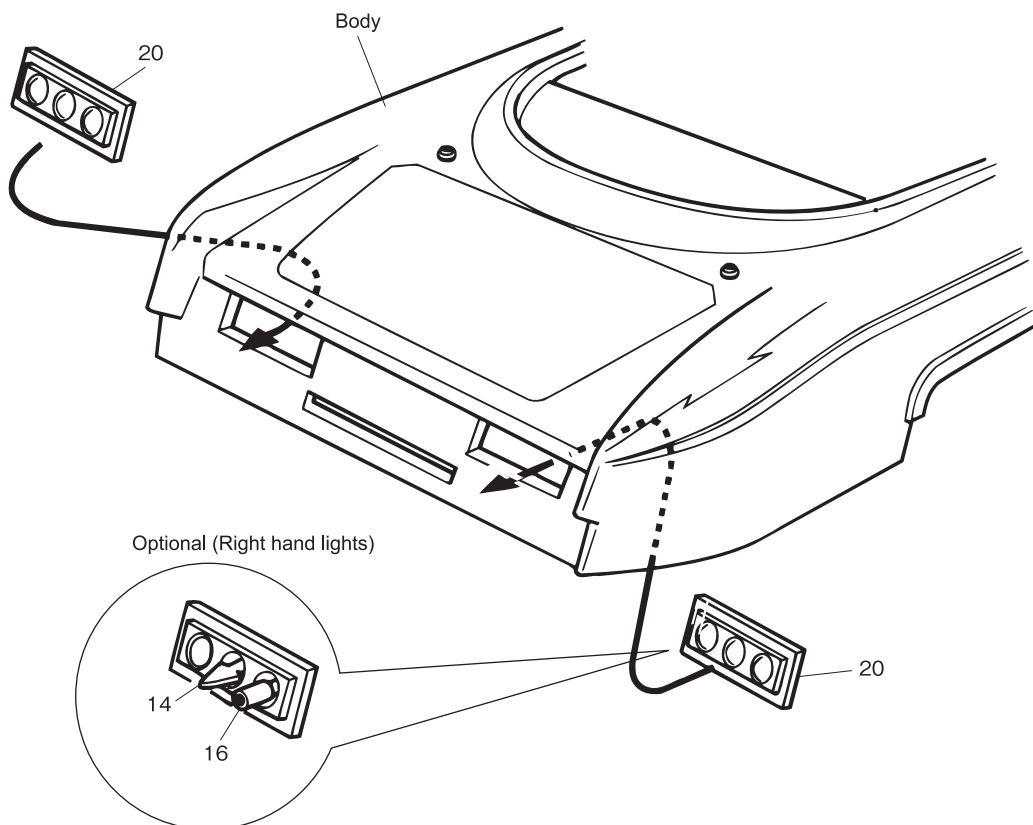

7 Body fittings

Secret weapon 16 is optional.

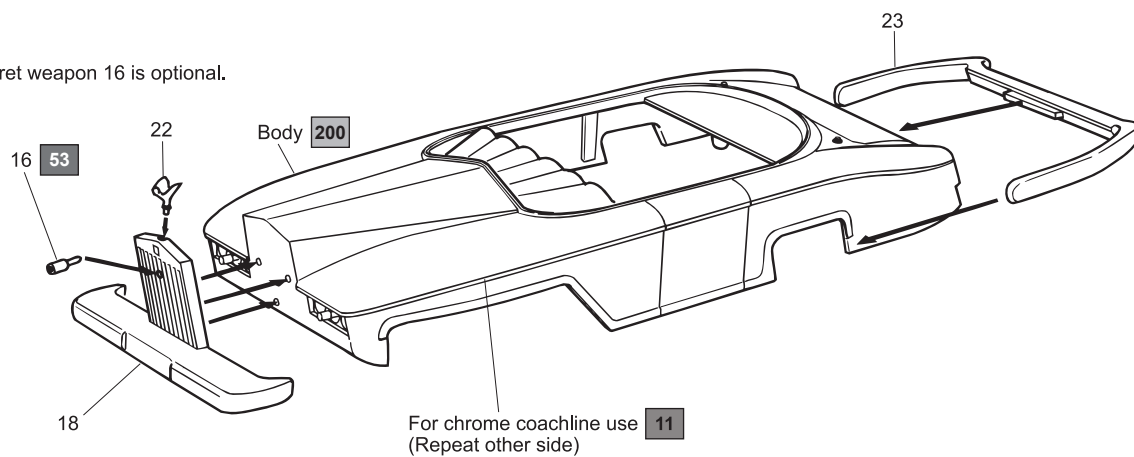

8 Body and chassis assembly

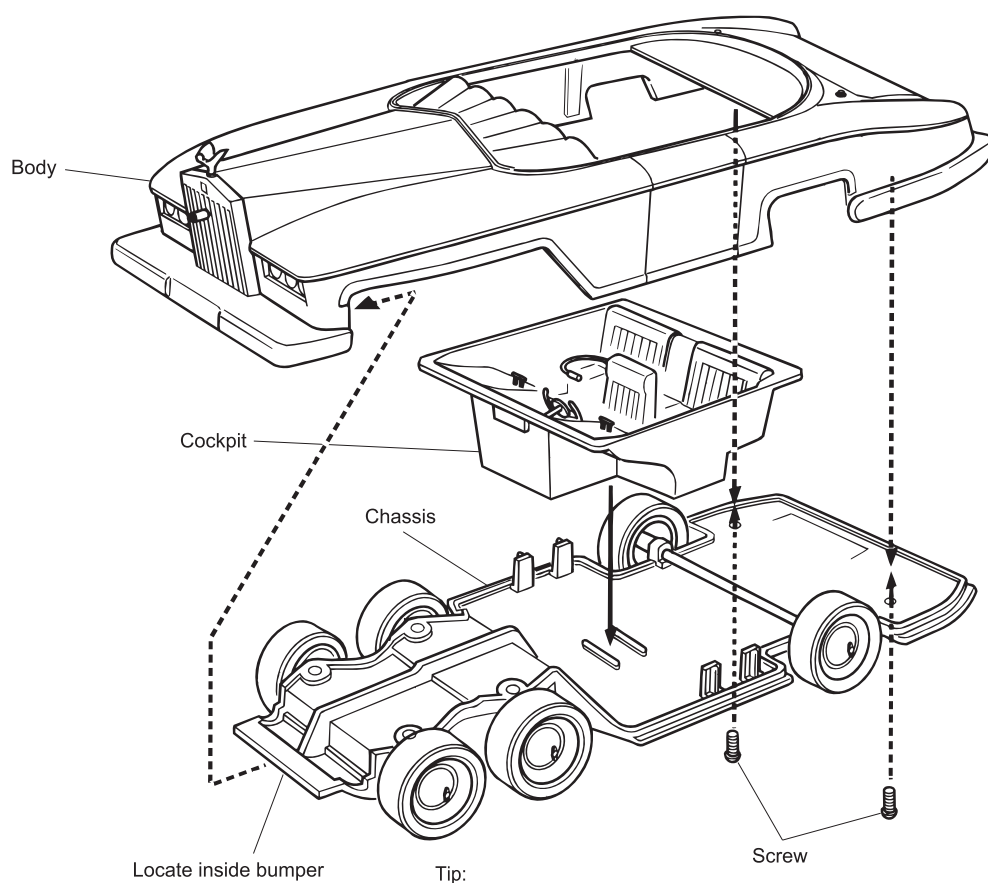

Tip:
The chassis is moulded in black.
Brush or spray 33 if preferred.

9 Canopy decoration

Affix decals in the order: ① ② ③

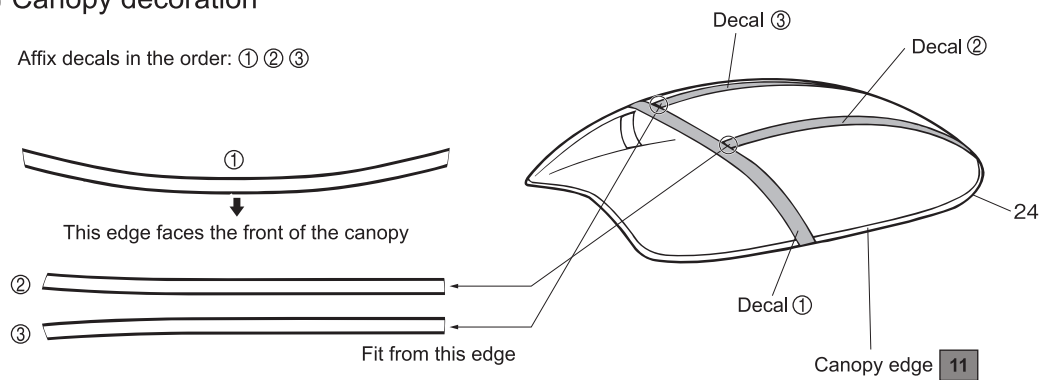

10 Final assembly

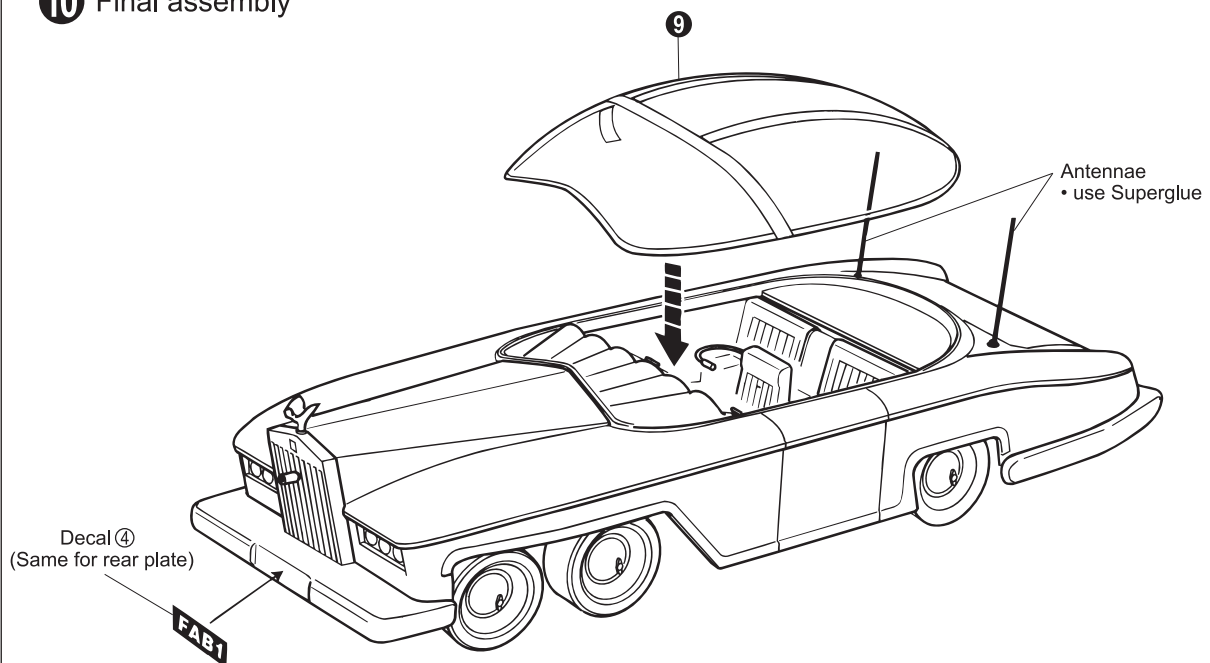

5, 4, 3, 2, 1... check out the rest of the range!

