

# COLLETT

## LOCO BODYSHELL CODES:-

**300-100 GWR GREEN (3202)**

**301-100 BR BLACK (2260)**

**302-100 BR LINED GREEN (2277)**

**ADD PRE-FIX 'T' FOR TENDER BODYSHELLS  
TO CODE NUMBERS QUOTED ABOVE.**

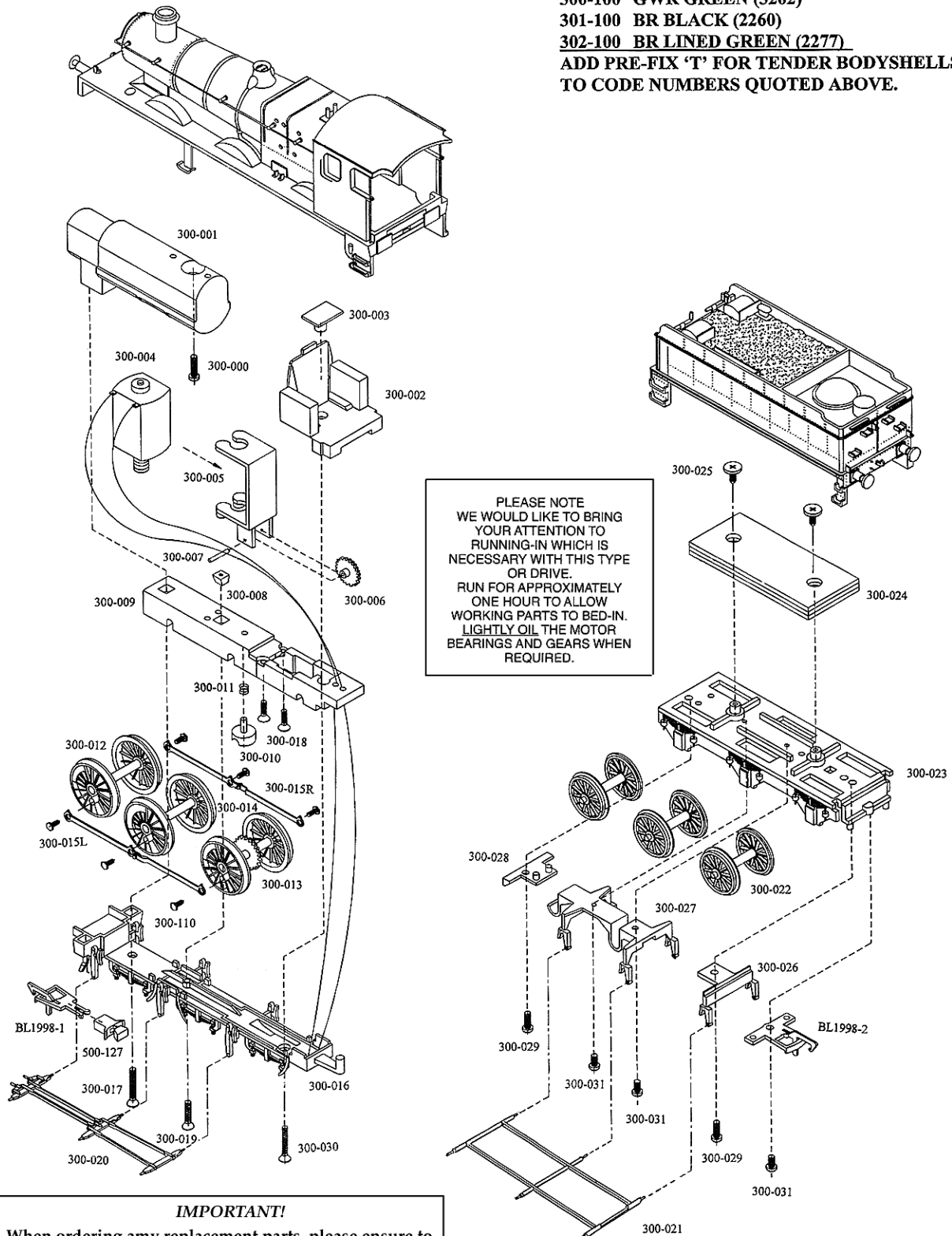

PLEASE NOTE  
WE WOULD LIKE TO BRING  
YOUR ATTENTION TO  
RUNNING-IN WHICH IS  
NECESSARY WITH THIS TYPE  
OR DRIVE.  
RUN FOR APPROXIMATELY  
ONE HOUR TO ALLOW  
WORKING PARTS TO BED-IN.  
LIGHTLY OIL THE MOTOR  
BEARINGS AND GEARS WHEN  
REQUIRED.

**IMPORTANT!**  
When ordering any replacement parts, please ensure to quote the appropriate catalogue number/Livery of your Bachmann Locomotive in addition to the part number required.  
Please quote the running number as well if required